

▼ Shown: FH604, FR400, AR630, C604, AH604, AR400



3/8" High-Flow Couplers

- Standard equipment on most Enerpac cylinders
- Recommended for use on all Enerpac pumps and cylinders where space and porting permits
- Includes "2-in-1" dust cap for use on male and female couplers.

3/8" High-Pressure 'Flush-face' Couplers

- Featuring "Push-to-connect" operation, to guarantee good connection every time
- Flush-face, zero-leak operation for minimal spillage and reduced pressure drop
- HTMA * recognized for safety and performance
- Will not interchange with low-pressure couplers.

3/8" Regular Spee-D-Couplers®

- For medium duty applications with hand pumps
- Includes female aluminum dust cap.

1/4" Regular Couplers

- For use with small cylinders and hand pumps
- Includes female aluminum dust cap.

1/4" Spin-on Torque Wrench Couplers

- For use with 10,000 psi S, W, RSL, DSX and HMT-Series torque wrenches, THQ-Series hoses and 10,000 psi torque pumps.

* Hydraulic Tool Manufacturers Association.

Quick Connection of Hydraulic Lines



Thread sealer

To seal NPTF-threads use one of the new anaerobic thread sealers or Teflon paste. When using Teflon Tape, apply the tape one thread from the end of a fitting to prevent it from winding up in the hydraulic system.



WARNING!

Couplers should be pressurized only when completely connected and should not be coupled or uncoupled when pressurized.
More safety instructions in our 'Yellow Pages'.

Page: 400



F-Series, Flush-faced couplers

Flush-faced couplers provide reduced pressure drop versus other types and are preferred in dirty, grimy construction and mining environments due to easy clean, non-dirt trapping faces.

▼ With the use of Enerpac high-flow couplers, hoses are easily installed for multiple hydraulic line connections in this 34 points PLC-controlled lifting system.



Hydraulic Couplers



CT604 Safety Tool

Use the Enerpac CT604 to relieve hydraulic back pressure by safely bleeding the hydraulic coupler.

NOTE: For use on CR400 and CH604 10,000 psi High-Flow Couplers only.

Minimize injuries from projectile parts and under-skin hydraulic fluid injections by eliminating unsafe coupler bleeding practices. The CT604 is Enerpac-engineering safe for use at 10,000 psi.

A, C, F, T Series



Maximum Flow Capacity:

462 - 2500 in³/min

Thread:

1/4" - 3/8" NPTF

Maximum Operating Pressure:

10,000 psi

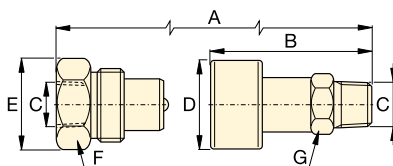

C604

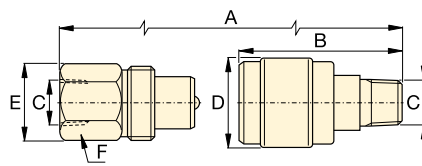

**A604
A630**

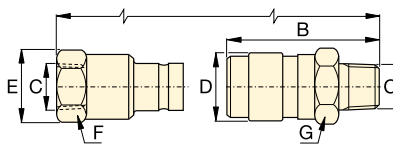

F604

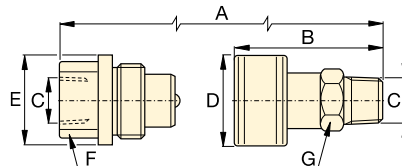

T630







Metal Dust Caps

Steel dust caps are available for the C604-Series couplers.

Order model number:

CD411M for female half

CD415M for male half

Maximum Flow Capacity (in ³ /min)	Coupler Type	Model Numbers			Dimensions (in)							Dust Cap(s) Model No.
		Complete Coupler Set	Female Half Coupler	Male Half Coupler	A *	B	C	D	E	F	G	
2100	10,000 psi High-Flow Coupler 	C604	CR400	CH604	3.26	2.87	3/8" NPTF	1.38	1.38	1.25	1.00	(2x) CD411
2500	10,000 psi Flush-Face Coupler 	F604	FR400	FH604	4.36	2.85	3/8" NPTF	1.23	1.23	1.06	1.12	—
462	10,000 psi Regular Spee-D-Coupler® 	A604	AR400	AH604	3.09	2.53	3/8" NPTF	1.12	0.94	0.94	0.73	Z410 female only
462	10,000 psi Regular Coupler 	A630	AR630	AH630	2.61	1.72	1/4" NPTF	0.87	0.81	0.75	0.57	Z640 female only
695	10,000 psi Spin-on Coupler 	T630	TR630	TH630	2.87	2.36	1/4" NPTF	1.14	1.14	0.74	0.82	—

* Value A is total length when male and female half are connected.